

Phone: 514-482-5984

Fax: 514-482-3685

sales@splicetronics.com

www.splicetronics.com



**Splicetronics Solutions**

*Splice Tape is used to join component reels and reduce pick & place machine down-time*

### Advantages:

- Stronger adhesive
- Significant savings on production costs
- Increase pick & place machine output 5%-30%
- Reduce reel change down-time
- Guarantees precise connection of reels
- Decrease machine abrasion by reducing the need to reload the feeder

### DOUBLE BLACK TAPE



### Description:

- Sizes: 8mm, 12mm, 16mm, 24mm
- Strip Strength:  $\geq 300\text{N/M}$
- Extending Rate: 55%
- Fire-retardant: 94v-0 class
- Insulating Grade: H
- Insulating Resistance:  $>10^6$
- Peel Strength: 16N/25mm
- Tensile Strength: 110 N/25mm
- Resist Voltage: 7KV
- Total Thickness: 0.025mm

### Instructions:

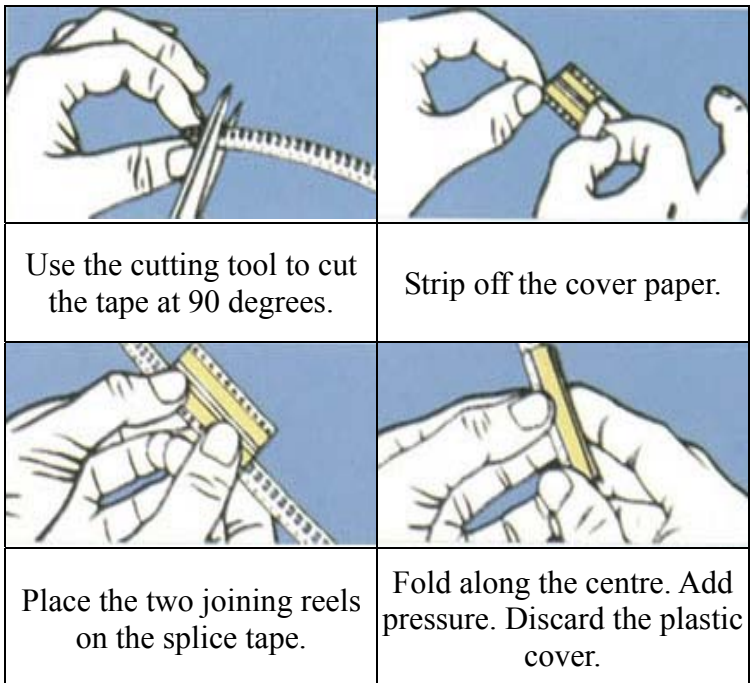

P/N	Category	Qty/Unit
DSC08	Double Black Splice Tape 8mm	500 pcs
DSC12	Double Black Splice Tape 12mm	500 pcs
DSC16	Double Black Splice Tape 16mm	500 pcs
DSC24	Double Black Splice Tape 24mm	500 pcs

**Splicetronics Solutions will allow you increase manufacturing productivity and reduce operational costs**