

Phone: 514-482-5984

Fax: 514-482-3685

sales@splicetronics.com

www.splicetronics.com



**Splicetronics Solutions**

*Splice Tape is used to join component reels and reduce pick & place machine down-time*

### Advantages:

- Custom designed for specific feeder models
- Holes guarantee precise connection of component reels
- Significant savings on production costs
- Increase pick & place machine output 5%-30%
- Reduce reel change down-time
- Decrease machine abrasion by reducing the need to reload the feeder

### BLUE SPLICE TAPE

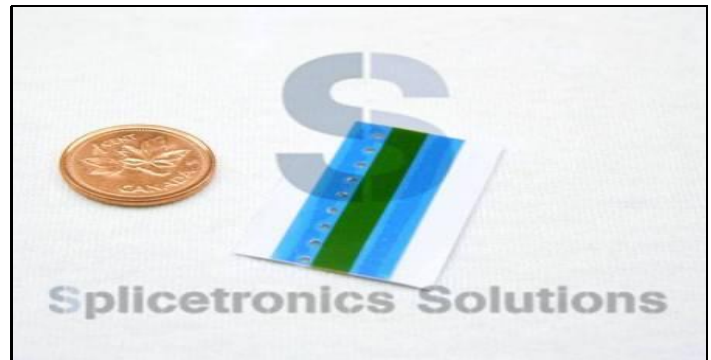

### Description:

- Sizes: 8mm
- Color: blue
- Strip Strength:  $\geq 300\text{N/M}$
- Extending Rate: 55%
- Fire-retardant: 94v-0 class
- Insulating Grade: H
- Insulating Resistance:  $>10^6$
- Peel Strength: 16N/25mm
- Tensile Strength: 110 N/25mm
- Resist Voltage: 7KV
- Total Thickness: 0.025mm

### Instructions:

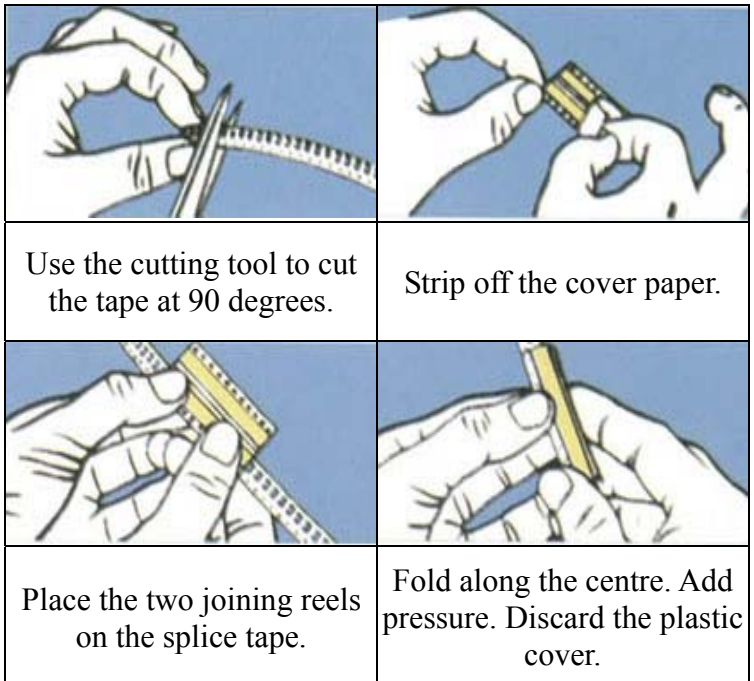

P/N	Category	Qty/Unit
DSJ08	8mm Blue Splice Tape	500 pcs

**Splicetronics Solutions will allow you increase manufacturing productivity and reduce operational costs**