

Phone: 514-482-5984

Fax: 514-482-3685

sales@splicetronics.com

www.splicetronics.com



Splicetronics Solutions

Splice Tape is used to join SMT component reels and reduce pick & place machine downtime

Advantages:

- Necessary for feeders with a special sensor
- Significant savings on production costs
- Increase pick & place machine output 5%-30%
- Reduce reel change downtime
- Guarantees precise connection of reels
- Decrease machine abrasion by reducing the need to reload the feeder

DOUBLE BLACK TAPE



Description:

- Sizes: 8mm - 44mm
- Backing Thickness (um): 25
- Total Thickness (um): 55±2
- Peel Strength (N/25mm)
 - to steel (25mm*20min): 13
- Retention (H) (25mm*25min): >100
- Tensile strength at break (N/25mm): >80
- Elongation at break (%): >90

Instructions:

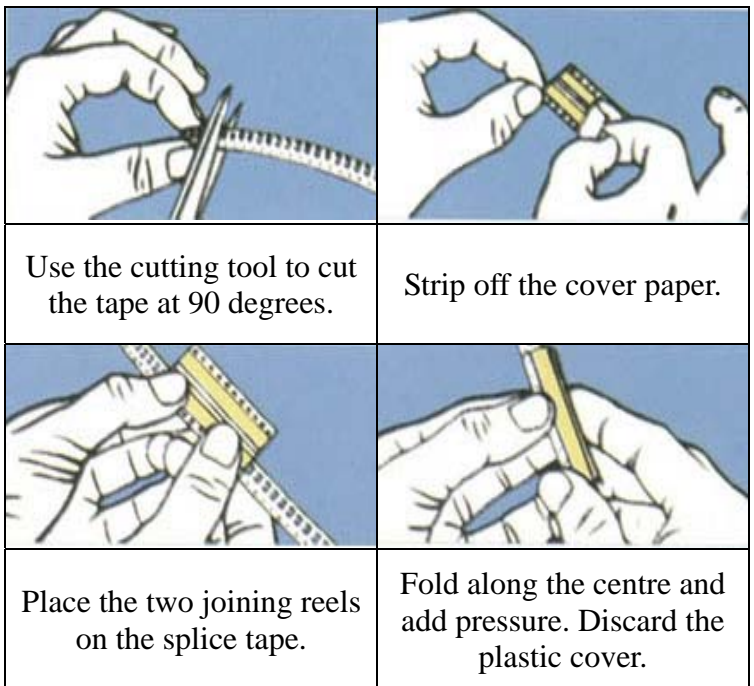

P/N	Category	Qty/Unit
DSP08	Double Black Splice Tape 8mm	500 pcs
DSP12	Double Black Splice Tape 12mm	500 pcs
DSP16	Double Black Splice Tape 16mm	500 pcs
DSP24	Double Black Splice Tape 24mm	250 pcs
DSP32	Double Black Splice Tape 32mm	250 pcs
DSP44	Double Black Splice Tape 44mm	250 pcs

Splicetronics Solutions will allow you to increase manufacturing productivity and reduce operational costs