

Phone: 514-482-5984

Fax: 514-482-3685

sales@splicetronics.com

www.splicetronics.com



Splicetronics Solutions

Splice Tape is used to join SMT component reels and reduce pick & place machine downtime

Advantages:

- Custom designed with eight hole placement
- Joins reels without the splicing tool and clip
- Significant savings on production costs
- Increase pick & place machine output 5%-30%
- Reduce reel change downtime
- Guarantees precise connection of reels
- Decrease machine abrasion by reducing the need to reload the feeder

8 HOLE DOUBLE SPLICE

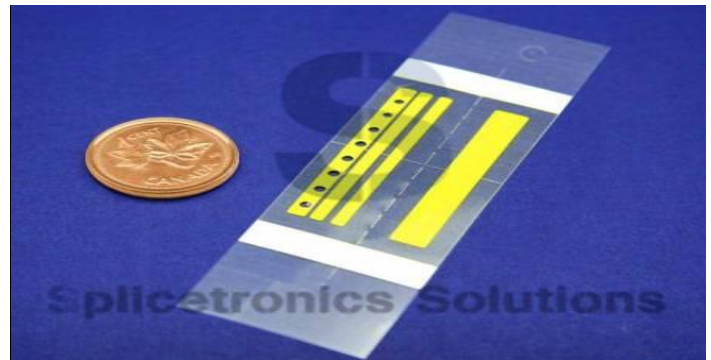

Description:

- Size: 8mm
- Backing Thickness (um): 25
- Total Thickness (um): 55±2
- Peel Strength (N/25mm)
 - to steel (25mm*20min): 13
- Retention (H) (25mm*25min): >100
- Tensile strength at break (N/25mm): >80
- Elongation at break (%): >90

Instructions:

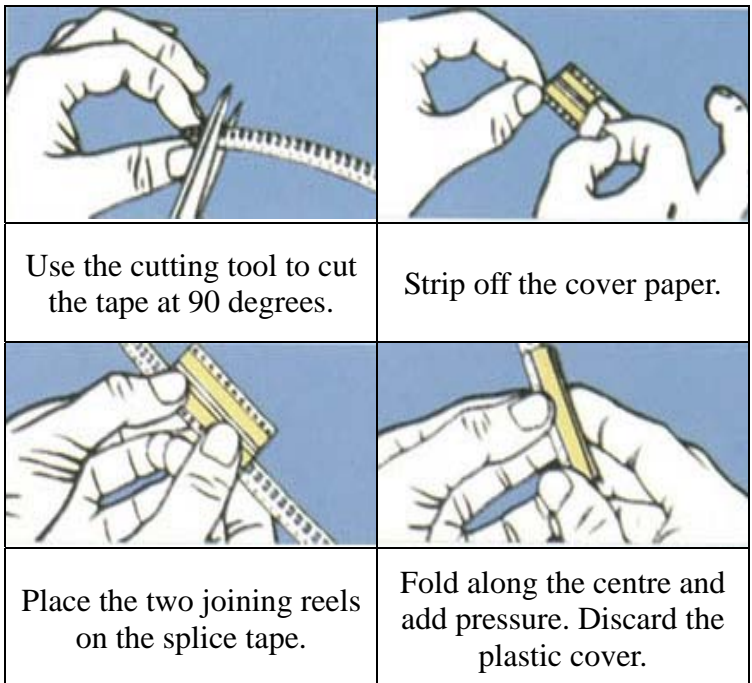

P/N	Category	Qty/Unit
DSU308	3pc Double Splice 8mm	500 pcs

Splicetronics Solutions will allow you to increase manufacturing productivity and reduce operational costs